

PLAT OF SURVEY

PART OF BLOCK 1 OF CARSWELL PARK

BEING A PART OF SECTION 35, TOWN 4 NORTH, RANGE 16 EAST,
TOWN OF LAGRANGE, WALWORTH COUNTY, WISCONSIN

3. The land referred to in the Commitment is described as follows:
Part of Block 1 of Carswells Park described as follows:
Situating in the Town of LaGrange, County of Walworth and State of Wisconsin:
Commencing at an iron stake, said stake being located 270 feet E following along the shore of Mill Lake from the SW corner of Lot 1 Block 1 of Carswells Park, thence N'ly following along the shore 100 feet to an iron stake, thence NW'ly 125 feet to an iron stake which is 20 feet from the NE corner of the above described parcel of land and on a line with the same NW'ly 55 feet to an iron stake, thence following along the shore of pond W'ly 50 feet to an iron stake; thence SE'ly 72 feet to an iron stake; thence NE'ly 56 feet to place of beginning. All of the above being in Block 1 of Carswells Park and being a portion of Section 35, T4N of R16E.
Commencing at an iron stake, said stake being located 370 feet from the SW corner of Block 1 of Carswells Park measured along the shore of Mill Lake E'ly 270 feet, thence N'ly 100 feet to said located stake; thence W'ly 50 feet to an iron stake; thence W'ly 96 feet to an iron stake; thence S'ly 30 feet to an iron stake; thence E'ly 125 feet to place of beginning.
ALSO the following described parcel of land lying W'ly across a 20 foot roadway, commencing at an iron stake 20 feet from the NW corner of the first described parcel of land; thence W'ly 36 feet to an iron stake; thence S'ly 25 feet to a stake; thence E'ly 55 feet to a stake which is 20 feet W'ly from the SW corner of the first described parcel of land; thence N'ly 27 feet to the place of beginning.
EXCEPTING THEREFROM land conveyed in Warranty Deed recorded in Vol. 305 of Records on page 356 as Document No. 91698 described as follows:
A parcel of land located in the Block 1 of Carswells Park and being a portion of Section 35, T4N, R16E, Walworth County, Wisconsin, described as follows, to-wit:
Beginning at a point located 420 feet measured along the shore of Mill Lake from the Southwest corner of Lot 1 Block 1 of Carswells Park, thence North 55° 44' 30" West along the Northerly line of land owned by William R. and Margaret C. Sellers 96.0 feet; thence South 32° 30' West 20.60 feet along the roadway; thence South 65° 24' East 12.89 feet; thence North 49° 05' East 4.67 feet; thence South 65° 24' East 82.45 feet to the place of beginning.
Tax Key No: HCA 00007

TOTAL AREA:
20,110 S.F. (0.46 AC.)

WORK ORDERED BY -
PETE WYKLE
177 TOWN ACRES LANE
ROSELLE, IL 60172

FARRIS, HANSEN & ASSOCIATES, INC.
ENGINEERING - ARCHITECTURE - SURVEYING
7 RIDGWAY COURT
ELKHORN, WISCONSIN 53121
OFFICE: (262) 723-2098 FAX: (262) 723-5886

REVISIONS

PROJECT NO.
7092
DATE:
06/30/2006
SHEET NO.
1 OF 1

- LEGEND
- = FOUND IRON PIPE STAKE
 - = FOUND IRON REBAR STAKE
 - * = FOUND DRILLED HOLE
 - ⦿ = SET IRON REBAR STAKE
 - ✕ = SET SPIKE
 - (XXX) = RECORDED AS

NOTE: COPIES OF THIS MAP TO WHICH THE FOLLOWING CERTIFICATE WILL APPLY SHOW THE SURVEYOR'S ORIGINAL SEAL AND SIGNATURE IN RED INK. COPIES BY ANY OTHER MEANS MAY HAVE ALTERATIONS WHICH DO NOT REPRESENT THE SURVEYOR'S WORK PRODUCT.

I HEREBY CERTIFY THAT THE ABOVE DESCRIBED PROPERTY HAS BEEN SURVEYED UNDER MY DIRECTION AND THAT THE ABOVE MAP IS A TRUE REPRESENTATION THEREOF AND SHOWS THE SIZE AND LOCATION OF THE PROPERTY, ITS EXTERIOR BOUNDARIES, THE LOCATION OF ALL VISIBLE STRUCTURES, AND DIMENSIONS OF ALL PRINCIPLE BUILDINGS THEREON, BOUNDARY FENCES, APPARENT EASEMENTS, ROADWAYS, AND VISIBLE ENCROACHMENTS, IF ANY. THIS SURVEY IS MADE FOR THE USE OF THE PRESENT OWNERS OF THE PROPERTY, AND ALSO THOSE WHO PURCHASE, MORTGAGE, OR GUARANTEE THE TITLE THERETO WITHIN ONE YEAR FROM THE DATE HEREOF.

DATED: JULY 12, 2013

PETER S. GORDON

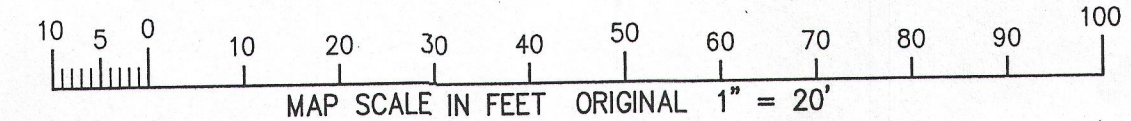
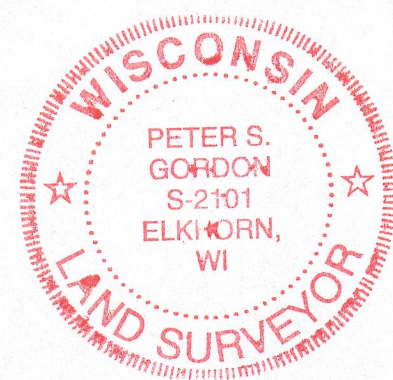

416-2657

JUL 12 2013

7/12/2013 x:\Projects\7092 SURVEY\SRV